

Serving the West Coast since 1983

# Project Bulletin WHITMAN HOSPITAL



## Office Building

### Project

Design and build a 5,500 sq. ft. permanent hospital office building.

### Project Details

The building site was located in Colfax (Eastern Washington). The appearance of the structure had to blend with an adjacent, older hospital. The building also had to be constructed to withstand harsh winter conditions, common in that area.

### Time to Complete

The project blueprints were approved on July 10th, 1999 and the building was delivered starting September 3rd, 1999. The building was completed on October 21st, 1999.

### Special Features

The client wanted a durable, low-maintenance building that would accent their existing buildings. The design features included a standing seam metal roof and concrete lapsiding (non-combustible).

FOR INFORMATION CALL:

Seattle, WA 877-225-5298

Portland, OR 877-267-3436

Chehalis, WA 800-225-6539

Boise, ID 208-362-6090

Pasco, WA 800-660-7174

Modesto, CA 800-441-8603



**WHITMAN HOSPITAL**

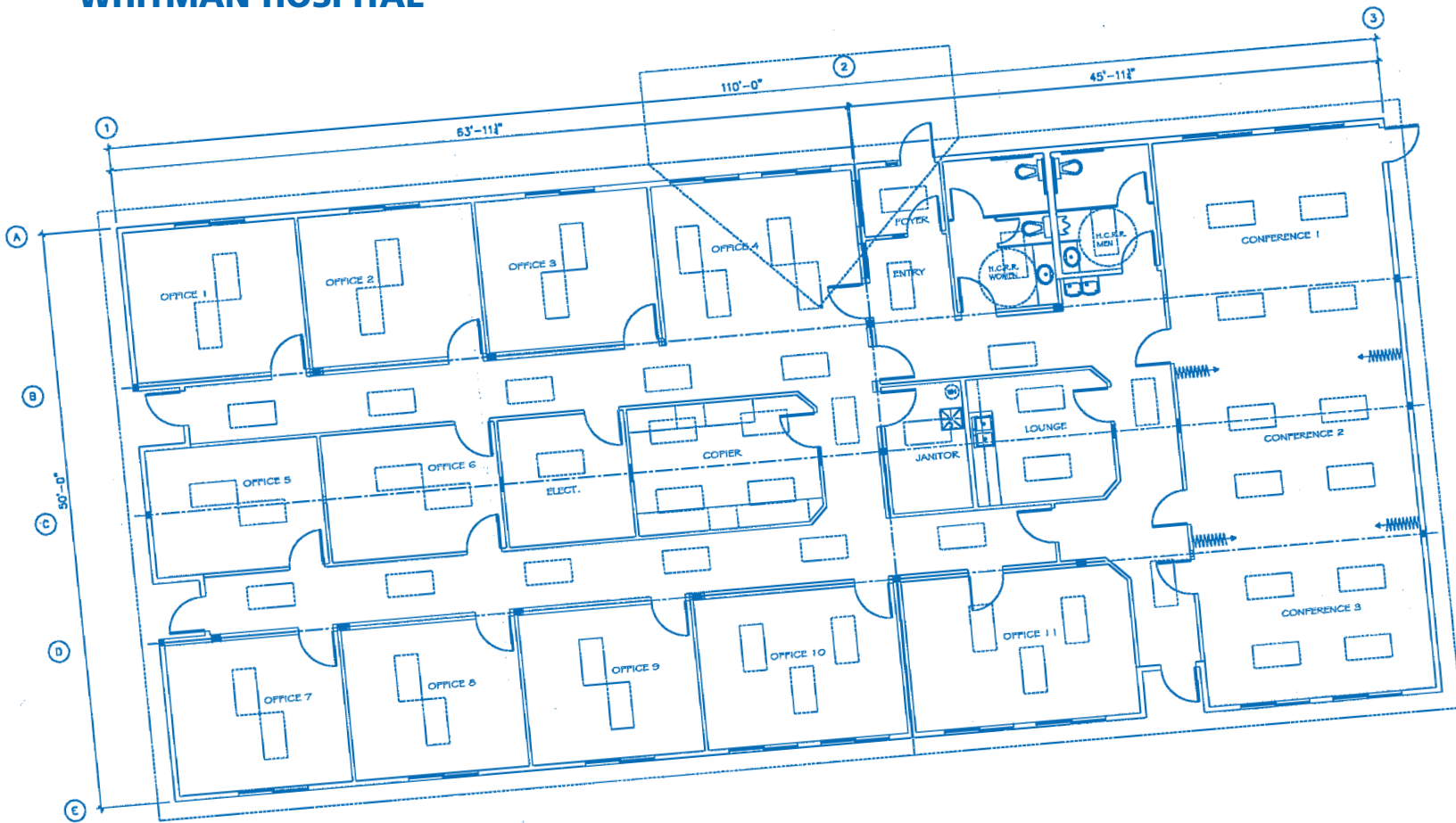

*Experience the difference!*

[www.pacificmobile.com](http://www.pacificmobile.com)

For Information Call:

Duane Harris at **800-225-6539**