



## Project Bulletin

### *Trans Alta*

#### Project

To supply approximately 25 job-site offices for new power plant construction.

#### Project Details

The building site was located in Centralia, Washington. The client needed a wide variety of offices from guard shacks to doublewides.

#### Time to Complete

Most buildings were delivered within one to two days of the initial request.

#### Special Features

A number of the doublewides were installed on hillsides requiring special blocking. Provided self-contained restroom units (placed inside buildings).

# Trans Alta



PO Box 1404  
Chehalis WA 98532-0350

## Features:

- 25 job-site offices
- single & doublewides
- self-contained restrooms
- modular construction
- required special blocking

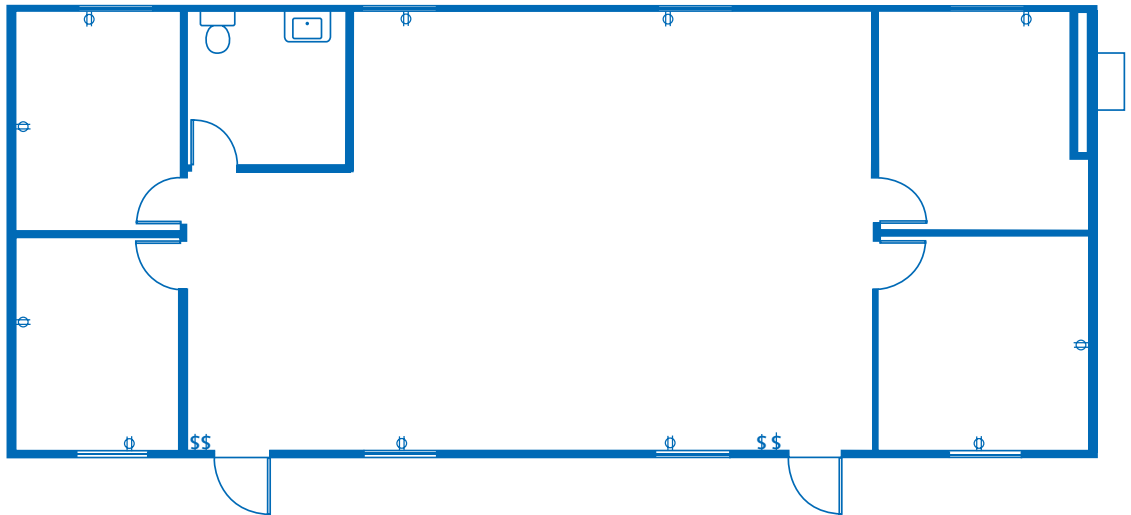

Feasibility Studies • Architectural Design • Project Management

*Experience the difference!*

[www.pacificmobile.com](http://www.pacificmobile.com)

For Information Call: **800.225.6539**

Serving the West Coast and the Northwest - Locations:

Seattle, WA

Chehalis, WA

Pasco, WA

Northern CA

Boise, ID

Portland, OR

Eugene, OR

Southern CA