



Project Bulletin

Muckleshoot School

Project

Installation of 3,136 square feet of BIA certified classroom space for the Muckleshoot Tribal School.

Project Details

The building site is located in Auburn, Washington. These buildings were designed to match existing buildings located adjacent to the site.

Time to Complete

Pacific Mobile was given the notice to proceed in June of 2004 and completed the project in early September in time for the start of fall classes.

Special Features

A concrete stemwall foundation was used which allowed access to the building at ground level. This eliminated the need for expensive ramp and deck construction at the same time giving it a more permanent look. An integrated whiteboard and tackboard wall system was designed by Pacific Mobile to meet the teacher's requirements.

Muckleshoot School



PO Box 1404
Chehalis WA 98532-0350

Features:

- 3,136 sq.ft.
- tribal school
- BIA certified classroom
- designed to match existing buildings
- modular construction
- concrete stemwall foundation

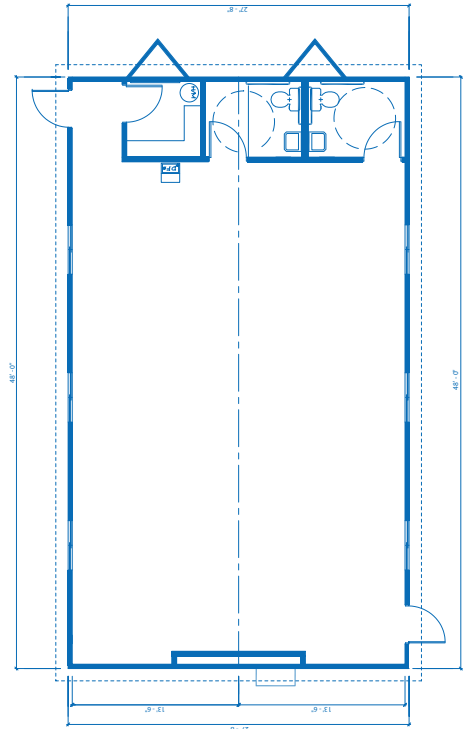
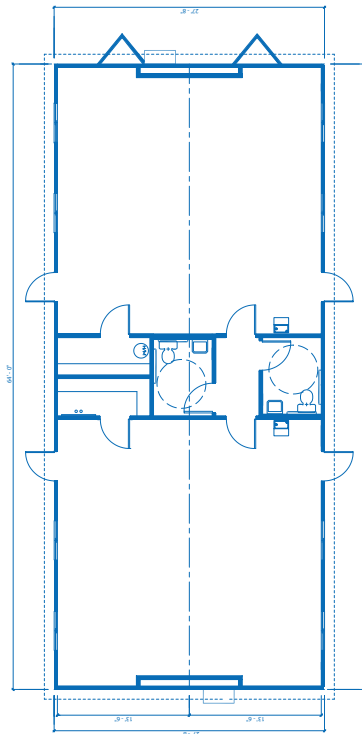

Feasibility Studies • Architectural Design • Project Management

Experience the difference!

www.pacificmobile.com

For Information Call: **800.225.6539**

Serving the West Coast and the Northwest - Locations:

Seattle, WA

Chehalis, WA

Pasco, WA

Northern CA

Boise, ID

Portland, OR

Eugene, OR

Southern CA