



Project Bulletin

Monroe Montessori

Project

Design and build a 2,900 sq. ft. permanent childcare building.

Project Details

The building site was located in Monroe, Washington. This structure had to be permanent, fit the design criteria of an adjacent residential community and meet the client's project budget. It also had to match an existing childcare building (located adjacent to the new facility).

Time to Complete

The project was approved October 1st, 1998 and was delivered January 13th, 1999. The building was completed on February 28, 1999.

Special Features

The client wanted a contemporary, attractive building that would appeal to an upscale clientele. The primary design feature was a 5 to 12 pitch, architectural shingle roof.

Monroe Montessori



PO Box 1404
Chehalis WA 98532-0350

Features:

- 2,900 sq.ft.
- design-build project
- 9' ceilings
- classrooms
- handicapped restroom
- modular construction
- permanent foundation

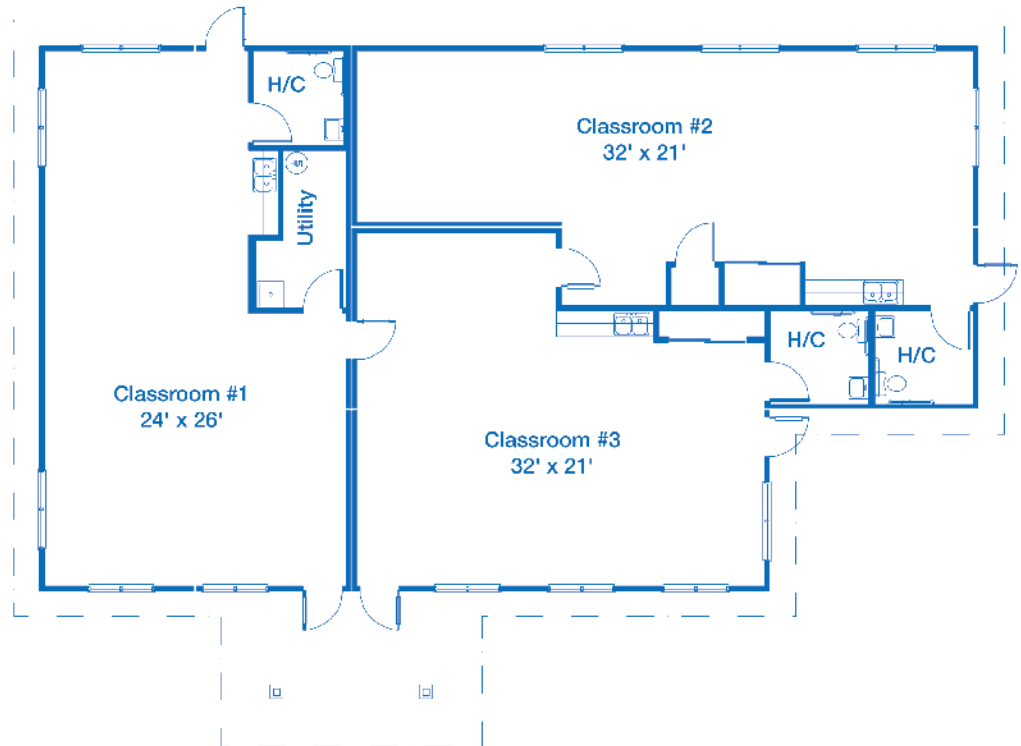

Feasibility Studies • Architectural Design • Project Management

Experience the difference!

www.pacificmobile.com

For Information Call: **800.225.6539**

Serving the West Coast and the Northwest - Locations:

Seattle, WA

Chehalis, WA

Pasco, WA

Northern CA

Boise, ID

Portland, OR

Eugene, OR

Southern CA