



Project Bulletin

Department of Energy Idaho National Laboratory

Project

To provide multiple office complexes totaling approximately 11,000 square feet at the Test Reactor Area for the decommissioning of a nuclear reactor.

Project Details

The building sizes ranged from a 12'x25' self-contained comfort station to a 56'x64' office complex with private offices and cubicles. The buildings are located on the Idaho National Laboratory site.

Time to Complete

Pacific Mobile was given a notice to proceed August 2005 and the client was able to occupy in September 2005. The project was completed on time and on budget with NO SAFETY VIOLATIONS.

Special Features

Each building met the necessary IBC, NEC and NFPA requirements. Pacific Mobile also provided a complete CAT 5 telecommunications system.

Pacific Mobile is an experienced DOE Small Business Contractor.



Contract Holder

FSS Contract GS-07F-5632R

Serving Government Agencies since 1983

Department of Energy Idaho National Laboratory



PO Box 1404
Chehalis WA 98532-0350

Features:

- 11,000 sq.ft.
- Office complex
- Heat pumps
- Design-build project
- 56'x64', 24'x60',
12'x25' restroom

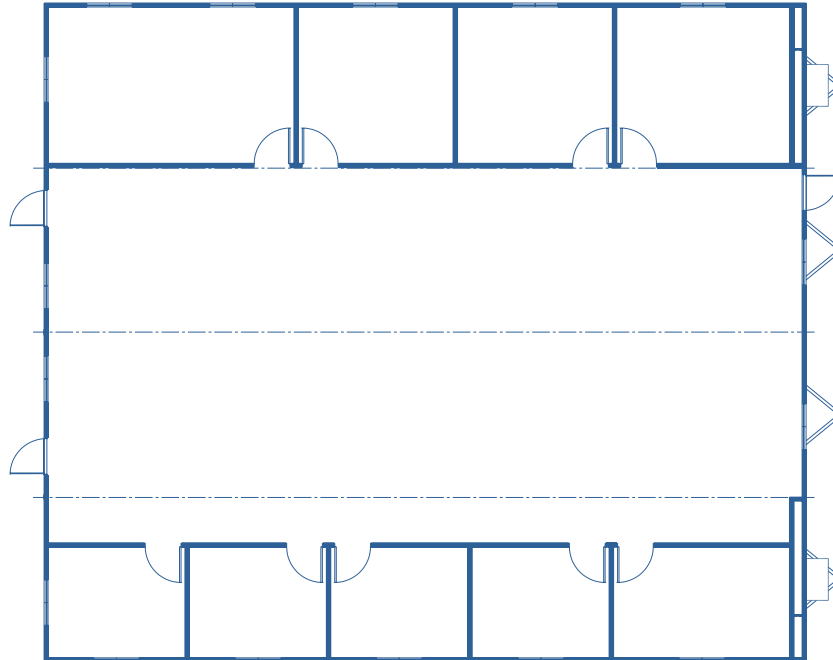

Project Management • DOE Approved Safety & Health Plan



For Modular Building GSA Opportunities contact:

Bill Ackerman – 800.660.7174 / bill@pacificmobile.com

Markus Alley – 800.660.0738 / markus@pacificmobile.com

ACCELERATED BUILDING SOLUTIONS

www.pacificmobilegsa.com



Contract Holder
FSS Contract GS-07F-5632R

Serving Government Agencies since 1983